

BLADE EJECTORS

INCH STANDARD

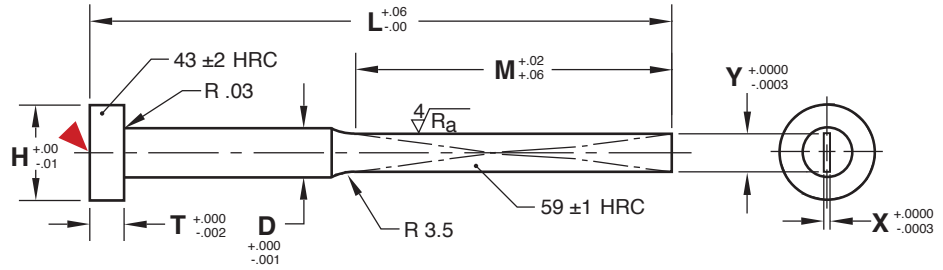

M 0-1 H 58-60 HRC

CAD insertion point

X	Y	D	H	T	L=6.5"	L=7.5"	L=10.5"
.0150	.0460	.062	.250	.125	BE062-015L6.5	BE062-015L7.5	—
.0150	.1000	.125	.250	.125	BE125-015L6.5	BE125-015L7.5	—
.0200	.0460	.062	.250	.125	BE062-020L6.5	BE062-020L7.5	—
.0200	.1000	.125	.250	.125	BE125-020L6.5	BE125-020L7.5	—
.0240	.1000	.125	.250	.125	BE125-024L6.5	BE125-024L7.5	—
.0240	.1400	.156	.281	.156	BE156-024L6.5	BE156-024L7.5	—
.0240	.1720	.187	.375	.187	BE187-024L6.5	BE187-024L7.5	—
.0320	.1000	.125	.250	.125	BE125-032L6.5	BE125-032L7.5	—
.0320	.1400	.156	.281	.156	BE156-032L6.5	BE156-032L7.5	—
.0320	.1720	.187	.375	.187	BE187-032L6.5	BE187-032L7.5	BE187-032L10.5
.0320	.2340	.250	.437	.187	BE250-032L6.5	BE250-032L7.5	BE250-032L10.5
.0320	.2960	.312	.500	.250	—	BE312-032L7.5	BE312-032L10.5
.0320	.3590	.375	.625	.250	—	BE375-032L7.5	BE375-032L10.5
.0460	.1000	.125	.250	.125	BE125-046L6.5	BE125-046L7.5	—
.0460	.1400	.156	.281	.156	BE156-046L6.5	BE156-046L7.5	—
.0460	.1720	.187	.375	.187	BE187-046L6.5	BE187-046L7.5	BE187-046L10.5
.0460	.2340	.250	.437	.187	BE250-046L6.5	BE250-046L7.5	BE250-046L10.5
.0460	.2960	.312	.500	.250	—	BE312-046L7.5	BE312-046L10.5
.0460	.3590	.375	.625	.250	—	BE375-046L7.5	BE375-046L10.5
.0620	.1720	.187	.375	.187	BE187-062L6.5	BE187-062L7.5	BE187-062L10.5
.0620	.2340	.250	.437	.187	BE250-062L6.5	BE250-062L7.5	BE250-062L10.5
.0620	.2960	.312	.500	.250	—	BE312-062L7.5	BE312-062L10.5
.0620	.3590	.375	.625	.250	—	BE375-062L7.5	BE375-062L10.5
.0780	.2960	.312	.500	.250	—	BE312-078L7.5	BE312-078L10.5
.0780	.3590	.375	.625	.250	—	BE375-078L7.5	BE375-078L10.5
.0780	.4840	.500	.750	.250	—	BE500-078L7.5	BE500-078L10.5
.0780	.5470	.562	.812	.250	—	BE562-078L7.5	BE562-078L10.5
.0780	.6090	.625	.875	.250	—	BE625-078L7.5	BE625-078L10.5
.0940	.4220	.437	.687	.250	—	BE437-094L7.5	BE437-094L10.5
.0940	.4840	.500	.750	.250	—	BE500-094L7.5	BE500-094L10.5
.0940	.5470	.562	.812	.250	—	BE562-094L7.5	BE562-094L10.5
.0940	.6090	.625	.875	.250	—	BE625-094L7.5	BE625-094L10.5
Blade Length M					M = 5"	M = 5"	M = 6"

For custom Blades, refer to the templates in section X.